

Fig 1. Side view of TT1/400 Tactile Corduroy Tile.

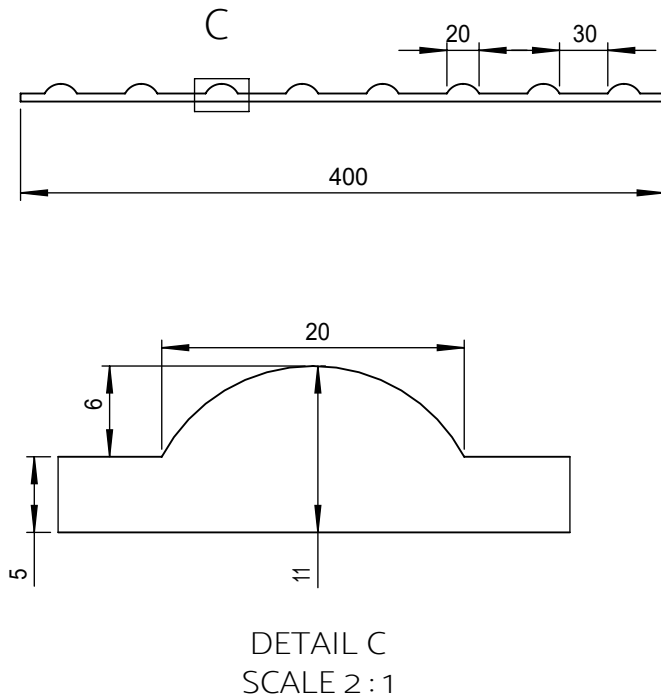
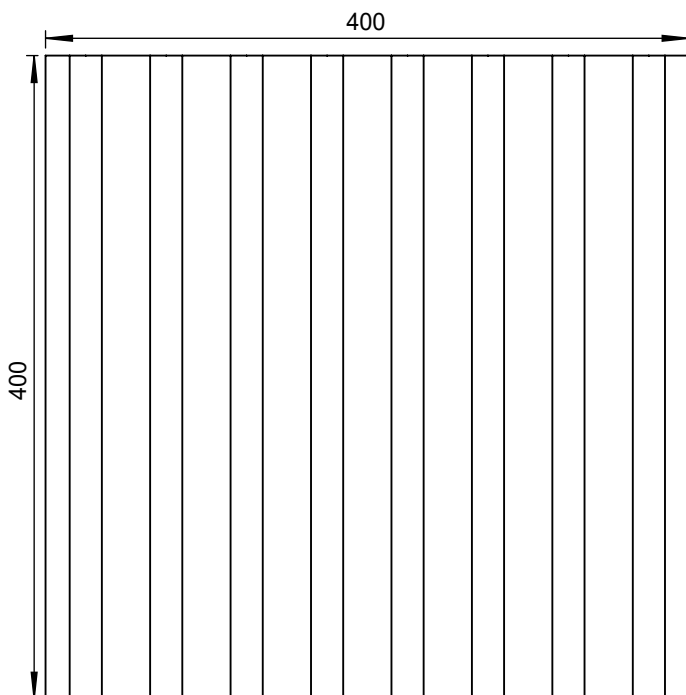

Fig 2. Plan view of TT1/400 Tactile Corduroy Tile.



Item: AATi Type TT1/400<sup>®</sup> (Open End) Cast Metal Tactile Tile with Silicon Carbide Granules cast into the metal matrix of the wearing surface.

**\*\*HDLT™:** This is a registered design- Protected by European Registered Design No. 002178178-0001.

Materials: Nickel Bronze, Gunmetal, Aluminium & Cast Iron (*\*zinc plated black*). Different materials increase the longevity of the product, please speak to AATi technical team for further information.

Application: For heavily used public stairways and Landing areas. These plates are purpose made in one or more pieces to suit the required stair width and as sets of strips to give the required 800mm of cover as per BS 8300:2009.

Environment: Metals are sustainably sourced coming from predominantly recycled origins and all the metals we use through our production process can be 100% recycled at our production facility

Compliance: This anti-slip floor plate provides colour contrast & slip resistance in accordance with British Standards BS 8300 & Building Regulations Part M & K. Please speak to our technical team to assist you with selecting the correct product and material for your application. Information on light reflectance values available upon request.

Cut to suit: Anti-slip floor plates can be produced to suit any stair width (Fig 2). However, individual profiles are as standard 400mm x 400mm (*subject to AATi tolerances*) in Cast Aluminium, Nickel Bronze & Gunmetal. Cast Iron (*\*zinc plated black*) are produced slightly thicker by +1.5mm. Longer lengths shall be supplied in multiple pieces. All products are supplied cut to length, pre-drilled and countersunk with production drawings submitted for client approval.

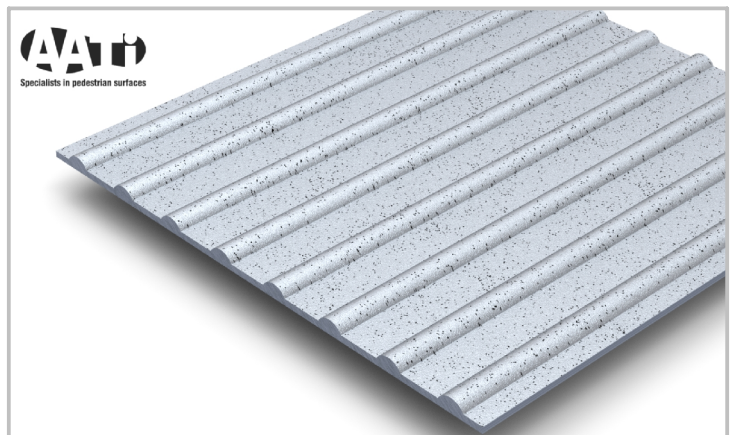

Fig 3. 3D view of TT1/400 Tactile Corduroy Tile.